

SS0600NB - SS0625B

SS600 SERIES STANDARD CHANNELS WITH BOTTOM OUTLET

PART NO.	INLET DEPTH	OUTLET DEPTH	SLOPE
SS0600NB	3.50 [88.90]	3.50 [88.90]	NEUTRAL
SS0605B	5.50 [139.70]	6.00 [152.40]	1%
SS0610B	8.00 [203.20]	8.50 [215.90]	
SS0615B	10.50 [266.70]	11.00 [279.40]	
SS0620B	13.00 [330.20]	13.50 [342.90]	
SS0625B	15.50 [393.70]	16.00 [406.40]	

ALL CHANNELS MADE FROM 16GA (0.062") 304 STAINLESS STEEL

CUSTOM CHANNEL LENGTHS AND MATERIAL AVAILABLE UPON REQUEST.

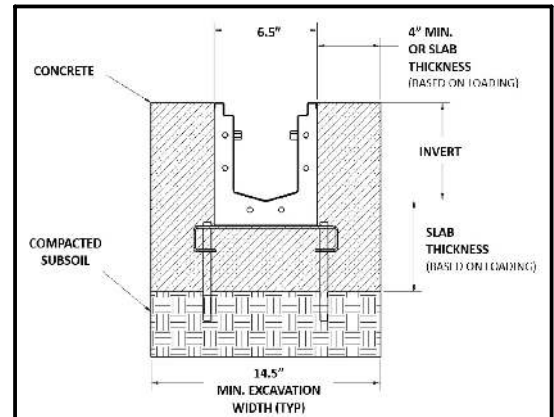

SPECIFYING ENGINEER IS RESPONSIBLE FOR CONCRETE ENCASEMENT AND REINFORCING BASED UPON APPLICATION AND LOCAL CODES

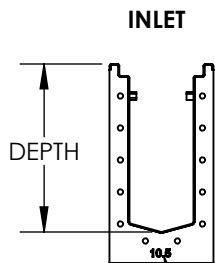
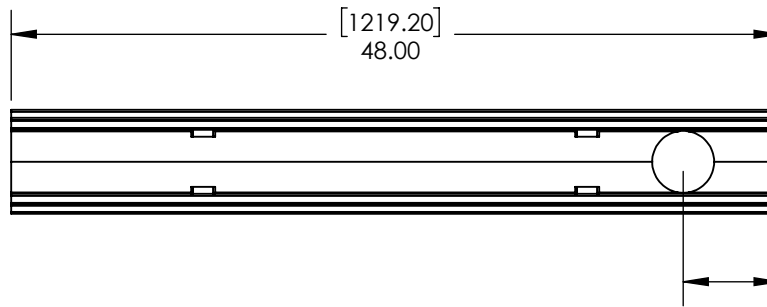

INLET

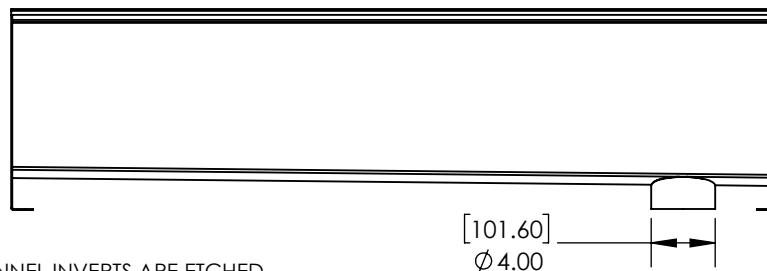

CHANNEL INVERTS ARE ETCHED INTO CHANNEL SUPPORTS TO INDENTIFY SLOPE

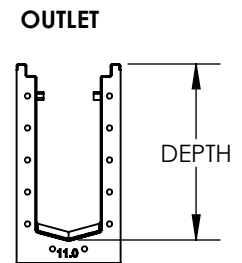

OUTLET

TDS RECCOMENDS USING A 4" FERNCO FITTING TO CONNECT OUTLET TO PLUMBING. (NOT INCLUDED)



DISCLAIMER - The customer and the customer's architects, engineers, consultants and other professionals are completely responsible for the selection, installation and maintenance of any product purchased from Trench Drain Systems and/or its manufacturers. TRENCH DRAIN SYSTEMS MAKES NO WARRANTY, EXPRESS OR IMPLIED, AS TO THE SUITABILITY, DESIGN, MERCHANTABILITY, OR FITNESS OF THE PRODUCT FOR CUSTOMERS APPLICATION. The drawing and information provided remain the property and copyright of the manufacturer listed. The manufacturer reserves the right to modify specification without notice.