

DG0622-DG0632	BRONZE AGE FOAM PATTERN 5.12" WIDE GRATE
---------------	------------------------------------------



PART NO.	MATERIAL	WEIGHT	OPEN AREA	FLOW RATE
DG0622	GALVANIZED	7 LBS.	19%	40.4 GPM PER LINEAR FOOT WITH 1/2" OF HEAD
DG0622H		4 LBS.		
DG0632	304 SS	7 LBS.		
DG0632H		4 LBS.		

DIN APPLICATION LOAD CLASS A: PEDESTIAN, RESIDENTIAL, BICYCLES AND GOLF CARTS
 DESIGNED FOR A DISTRIBUTED PRESSURE OF 3,372 LBS. (15kN)

MEETS THE FOLLOWING STANDARDS & SPECIFICATION:

- THE AMERICANS WITH DISABILITIES ACT OF 1990: 4.5.4.
- ASME A112.6.3. SECTION 7.12 HEEL RESISTANT STRAINERS AND GRATES.

SYSTEM MFG	SYSTEM	LOCKING DEVICE
HUBBELL	POLYCAST 500	DA0542S
	POLYCAST 600	DA0642S
TDS	SS0500	SS0542S
	SS0600	SS0642S

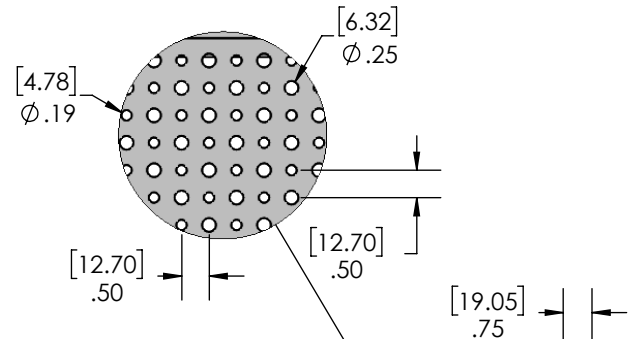

COUNTER-SUNK THRU HOLE FOR 3/8" HARDWARE. (QTY. 2) ON 48" AND (QTY. 1) ON 24"

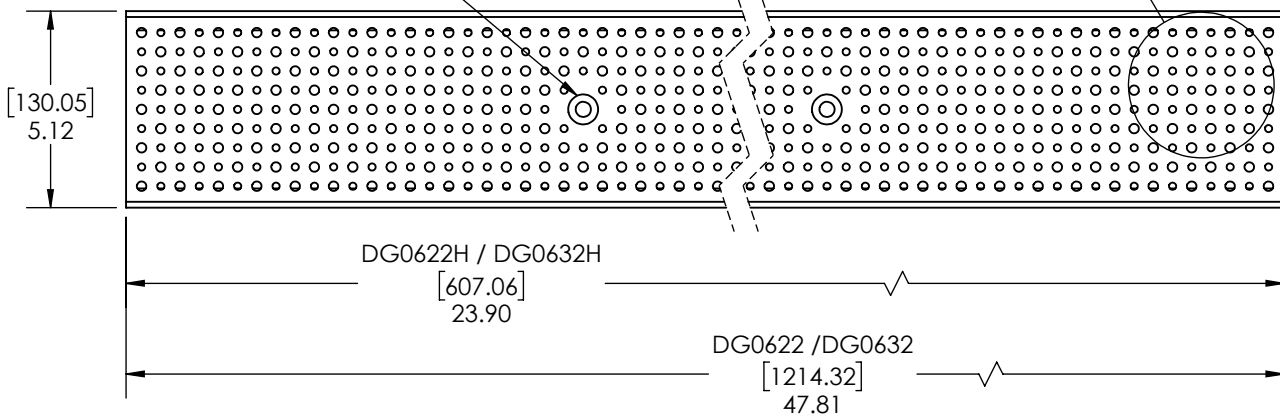

DISCLAIMER - The customer and the customer's architects, engineers, consultants and other professionals are completely responsible for the selection, installation and maintenance of any product purchased from Trench Drain Systems and/or its manufacturers. TRENCH DRAIN SYSTEMS MAKES NO WARRANTY, EXPRESS OR IMPLIED, AS TO THE SUITABILITY, DESIGN, MERCHANTABILITY, OR FITNESS OF THE PRODUCT FOR CUSTOMERS APPLICATION. The drawing and information provided remain the property and copyright of the manufacturer listed. The manufacturer reserves the right to modify specification without notice.