



610-638-1221
sales@trenchdrain.com
 PO BOX 377 - FREMONT, OH 43420

PROJECT ID: _____
 CONTRACT NO: _____
 LOCATION: _____

RELEASED 5.13.20

LD100-1	LOCKING DEVICE FOR ULMA UK SERIES & HYDROPLUS w/GALVANIZED MESH GRATE
---------	---

GRATE TYPE	PART NO.		EN-1433 LOAD CLASS
	0.5M	1M	
GALVANIZED STEEL MESH	403 (GEX100KCBM)	402 (GEX100KCB)	B125
GALVANIZED STEEL MESH HEEL-PROOF	407 (GEHX100KCBM)	406 (GEHX100KCB)	B125

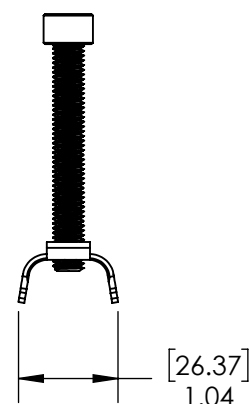
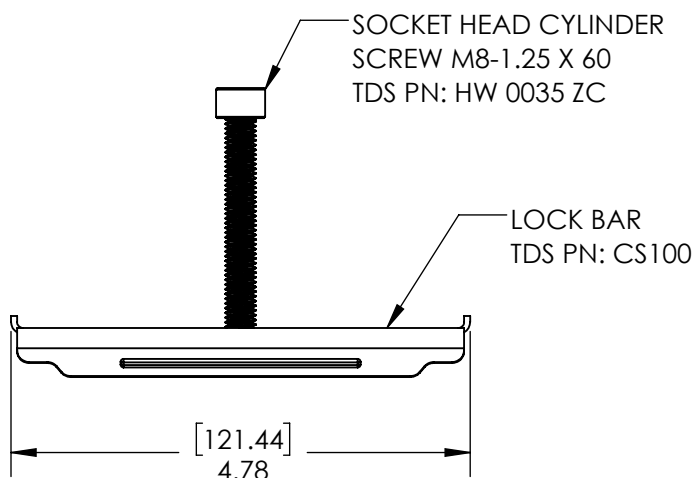
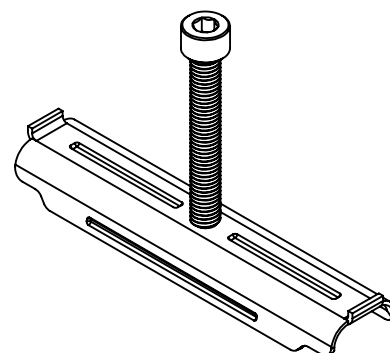

MANUFACTURER



SPECIFICATION

ULMA LD100-1 SERIES LOCKING DEVICES ARE TO BE USED WITH ALL GRATING SYSTEMS WHERE WHEEL TRAFFIC OCCURS. THIS IS NECESSARY TO PROVIDE SYSTEM INTEGRITY. USED ON ULMA UK SERIES AND HYDROPLUS SYSTEMS.

DISCLAIMER - The customer and the customer's architects, engineers, consultants, and other professionals are completely responsible for the selection installation and maintenance of any product purchased from Trench Drain Systems and/or its manufacturers. TRENCH DRAIN SYSTEMS MAKES NO WARRANTY, EXPRESS OR IMPLIED, AS TO THE SUITABILITY, DESIGN, MERCHANTABILITY, OR FITNESS OF THE PRODUCT FOR CUSTOMERS APPLICATION. The drawing and information provided remain the property and copyright of the manufacturer listed. The manufacturer reserves the right to modify specification without notice.