

# TRENCH DRAIN CATCH BASIN

» 865 SERIES

HydroTec™

## SPECIFICATION

Sioux Chief 865 Series HydroTec Maxi 300 fiber-reinforced concrete catch basin shall be used where necessary for surface drainage. Catch basin shall incorporate a galvanized debris basket, ductile iron edge rails and Class E, ADA-compliant ductile iron grate. All concrete thickness and reinforcement per structural engineer's specification for the application. Designed in accordance with ASME A112.6.3

## MATERIALS

**Catch Basin:** Fiber-reinforced concrete

**Edge Rails:** Ductile iron

**Grating:** Ductile iron (ASTM A536 70-50-05) with 'F1' lock-down system

## GRATE INTAKE AREA

81.3 in<sup>2</sup>

## LOAD RATING

DIN EN 1433 - Class E

ITEM # SUBMITTED	_____
JOB NAME	_____
LOCATION	_____
ENGINEER	_____
CONTRACTOR	_____
PO#	_____ TAG _____

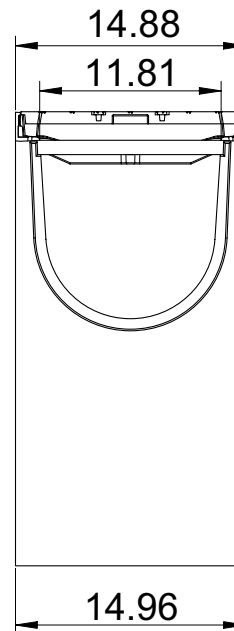
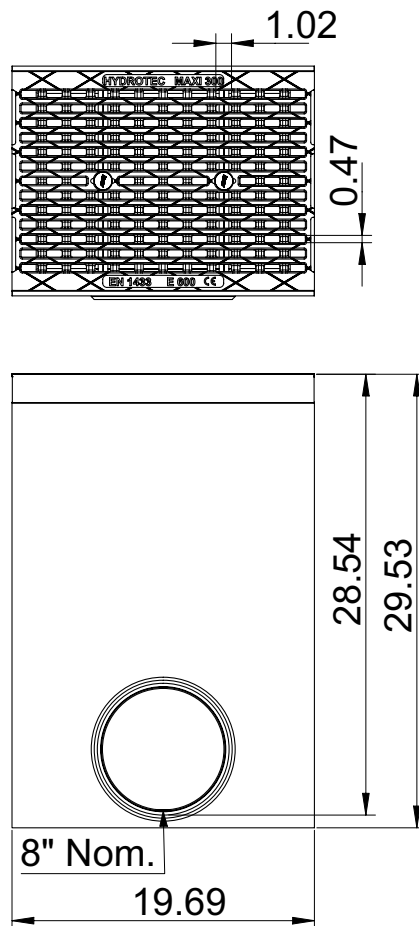

Item Number

**865-M12PCBEA**

Accessories - Available Separately:  
865-8PC: PVC S&D connection pipe for 8" Nom. outlets