



Fiberglass Rail installation

EZ and Wye Frames

Typical trench construction is comprised of a trench form, concrete floor, rebar and fill (usually soil or stone). *Figure 1*

Step 1: Attach nailer to the trench form. Securely attach a wooden nailer to the trench form on the side where the grating will fit into the fiberglass rail. See chart for recommended nailer size. *Figure 2*

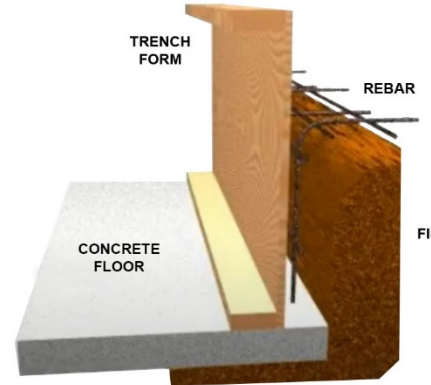

Figure 1

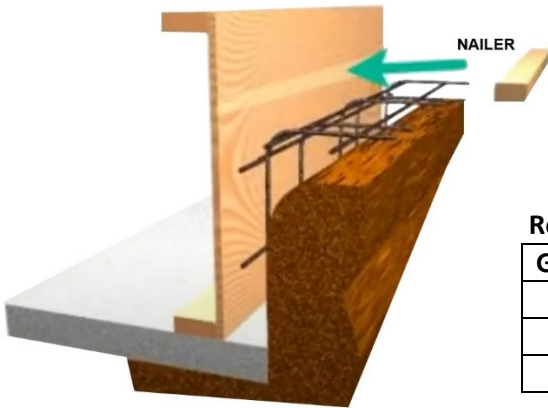

Figure 2

Recommended Nailer Si

GRATING	NAILER SIZE
1"	1" x 1.5"
1.5"	1.5" x 2"
2"	2" x 1.5"

Step 2: Attach the fiberglass rail to the wooden nailer using small finish nails (drill holes in the rails to facilitate the process at 2' to 3' intervals). *Figure 3*

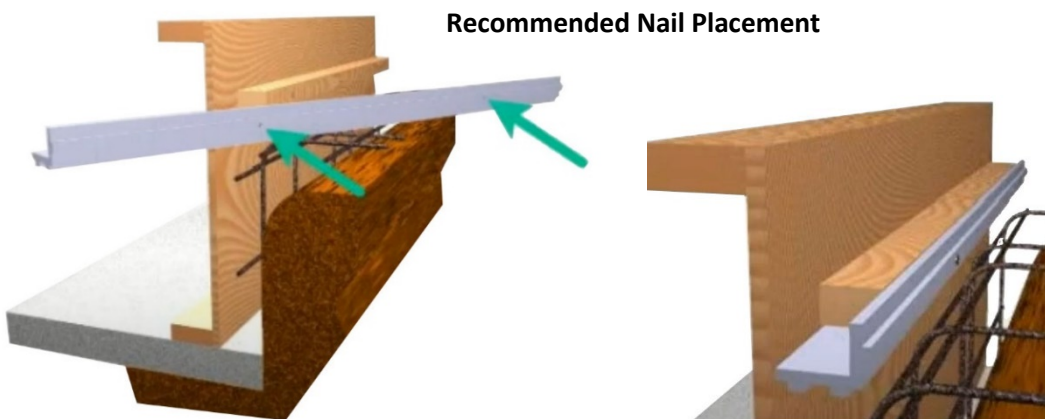

Figure 3

Step 3: Pour concrete as normal. Limited vibration is needed to obtain complete fill out around the locking lugs on the concrete site of the fiberglass rails. *Figure 4*

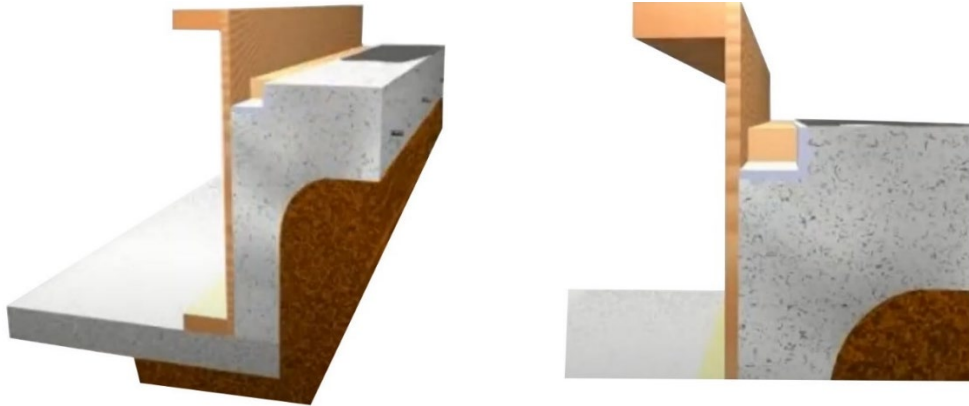

Figure 4

Step 4: Allow for adequate cure time before removing form is important to ensure the strength of the trench. 30 Days is recommended but it may be dependent on the thickness and/or the amount of concrete poured. Remove form. *Figure 5*

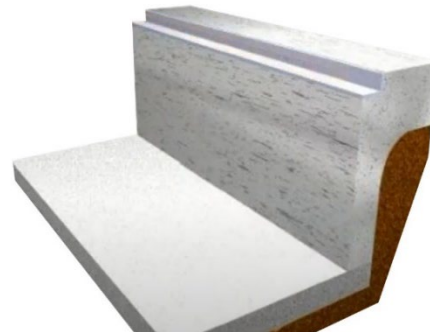

Figure 5

Step 5: After removing form, clip or grind finishing nails flush to surface of fiberglass rails. Seal holes with an epoxy sealing kit. *Figure 6*

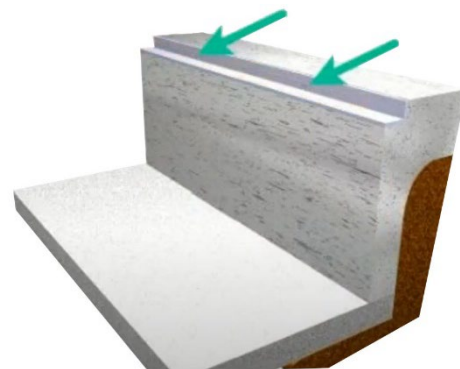

Figure 6

Step 6: Position grates to rest on the rails. *Figure 7*

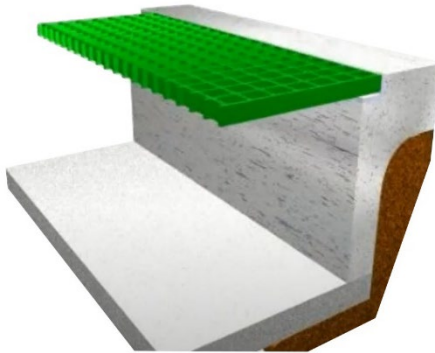



Figure 7

SPECIFICATIONS

Disclaimer – the customer and the customers architects, engineers, consultants and other professionals are completely responsible for the selection installation and maintenance of any products purchased from Trench Drain Systems and/or its manufacturers. Trench Drain Systems makes no warranty, express or implied, as to the suitability, design, merchantability, or fitness of the product for customers application. The drawing and information provided remain the property and copyright of the manufacturer listed. The manufacturer reserves the right to modify the specification without notice.

For specific questions contact TDS product specialist or engineer at (610) 638-1221

	⚠ WARNING
	IMPORTANT SAFETY INFORMATION INSIDE <ul style="list-style-type: none">• Serious injury or death possible• Read, understand, and follow all safety information and instructions in this manual before using or servicing this product.• Retain these instructions for future reference.