



610-638-1221
sales@trenchdrain.com
PO BOX 377 - FREMONT, OH 43420

PROJECT ID: _____
CONTRACT NO: _____

LOCATION: _____

RELEASED: 7.20.20
REVISION: -

DP0500

POLYCAST 500 SERIES CHANNEL

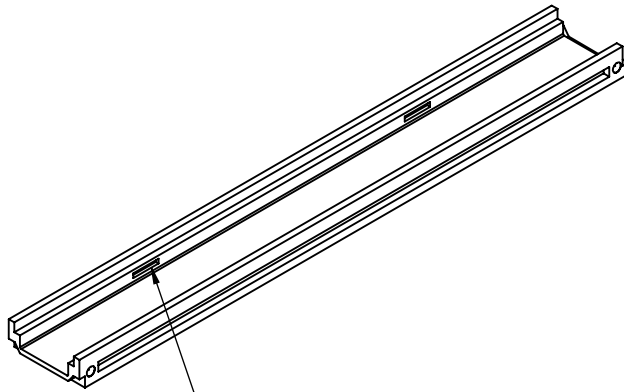

INTEGRAL GROOVE
FOR LOCKING DEVICES

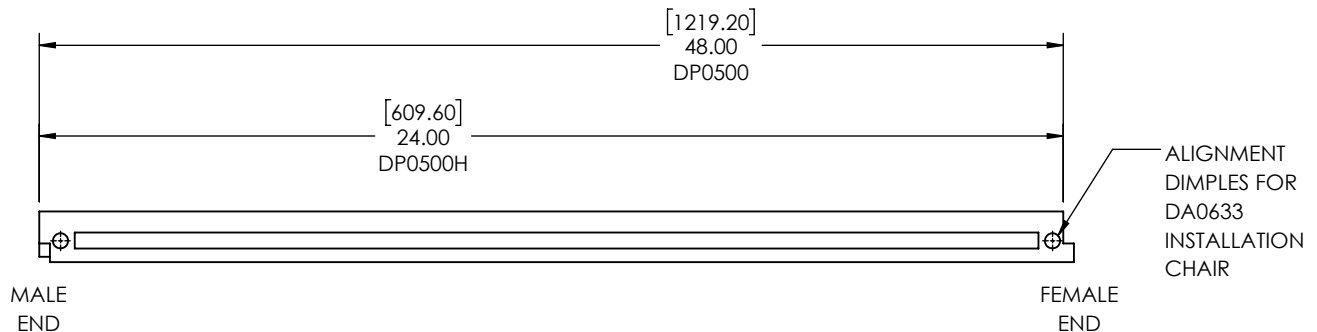
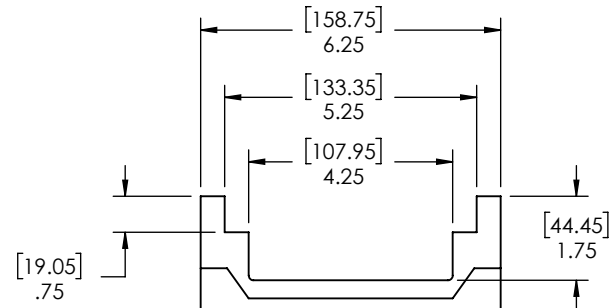

BOTTOM OUTLET; CORE DRILLING REQUIRED
3.0" SCH 40 & 80 PVC USE DRILL SIZE 3.50"
4.0" SCH 40 & 80 PVC USE DRILL SIZE 4.50"
4.0" SDR-35 SEWER & DRAIN USE DRILL SIZE 4.25"



MANUFACTURER

POLYCAST®

DISCLAIMER - The customer and the customer's architects, engineers, consultants, and other professionals are completely responsible for the selection installation and maintenance of any product purchased from Trench Drain Systems and/or its manufacturers. TRENCH DRAIN SYSTEMS MAKES NO WARRANTY, EXPRESS OR IMPLIED, AS TO THE SUITABILITY, DESIGN, MERCHANTABILITY, OR FITNESS OF THE PRODUCT FOR CUSTOMERS APPLICATION. The drawing and information provided remain the property and copyright of the manufacturer listed. The manufacturer reserves the right to modify specification without notice.

ENGINEERING SPECIFICATION

POLYCAST 500 SERIES SHALLOW NON-SLOPED TRENCH DRAIN SYSTEM IS A NON-SLOPING TRENCH DRAIN WITH 6 1/4" WIDE X A NOMINAL 48" LONG POLYESTER POLYMER CONCRETE CHANNELS WITH TONGUE AND GROOVE CONNECTIONS. CHANNEL WILL BE SUPPLIED WITH DRILL OUTS FOR 4" BOTTOM OUTLET. INSTALLATION CHAIRS RECOMENDED FOR INSTALLATION.