

**Top**

Scale 1:2

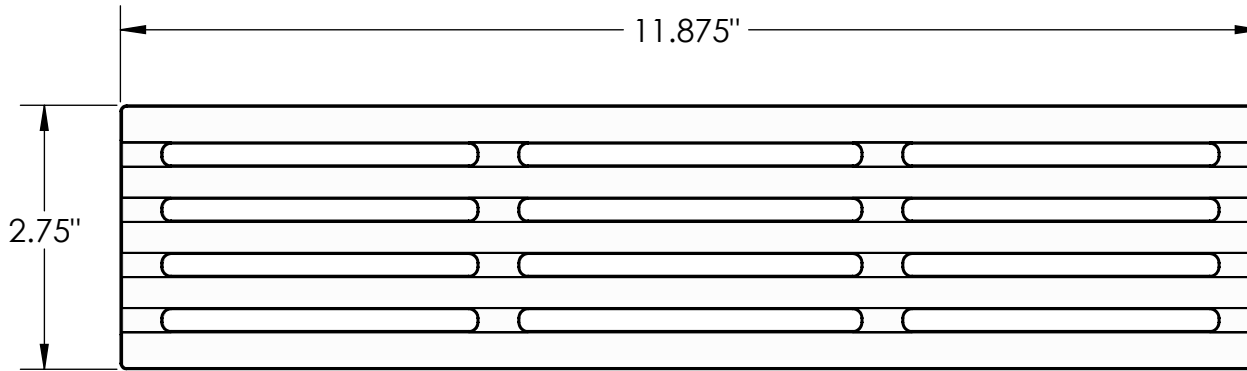

**Side**

Scale 1:2



**Bottom**

Scale 1:2

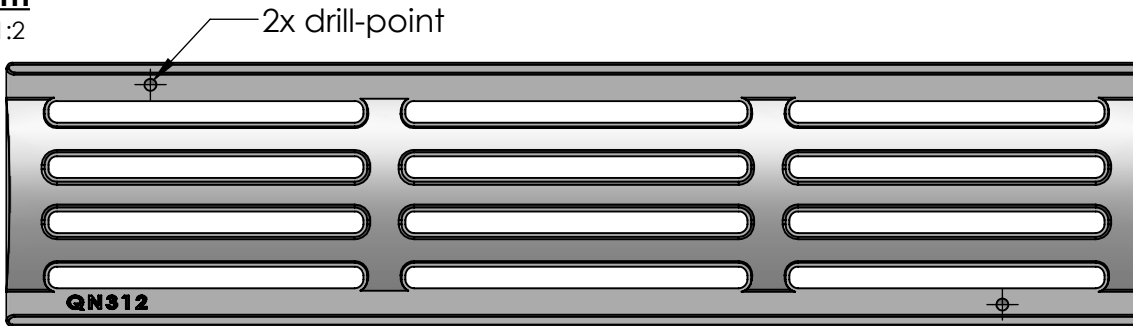

**Edge**

Scale 1:1

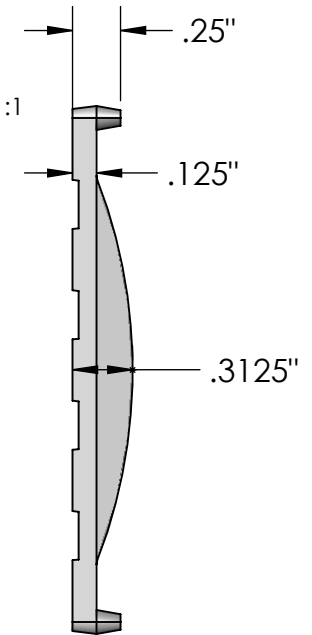

**Perspective**

Scale 1:23

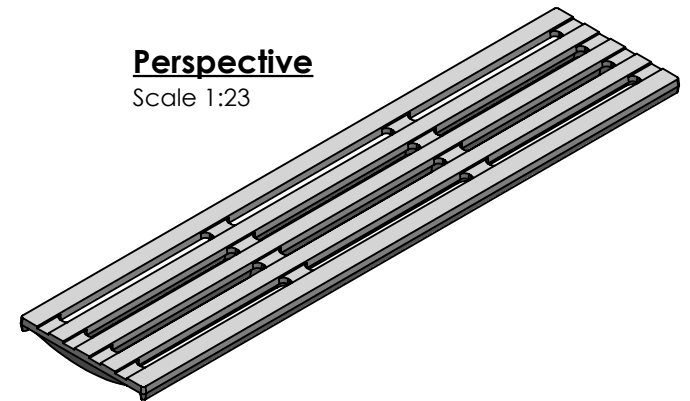

 **IRON AGE** 2104 SW 152nd st #4 TEL 206.276.0925  
 DESIGNS Burién, WA 98166 FAX 206.257.0318  
 www.ironagedesigns.com

**Que 3"x12" Trench Grate**

JOB NO. 141021IG3 - Laver

Drawn by: JH

DWG. NO. 01-QUE.N.3x12

Date: 12/3/14

Scale: Not to Scale

**NOTES:**

1. Material: cast ductile iron
2. Finish: **Natural**
3. Edge thickness: 1/4"
4. Fits frame by: **NDS Mini- Channel**
5. Heelproof; No openings greater than 1/4"
6. Weight approx. **2 lbs.**
7. Due to casting inconsistencies all dimensions are nominal