

x3 Arrayed

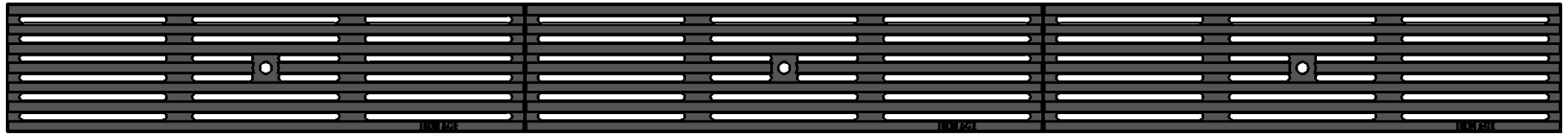

TOP

19.625"

0.38"

0.8125"

0.0625"

4.81"

EDGE

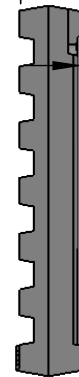
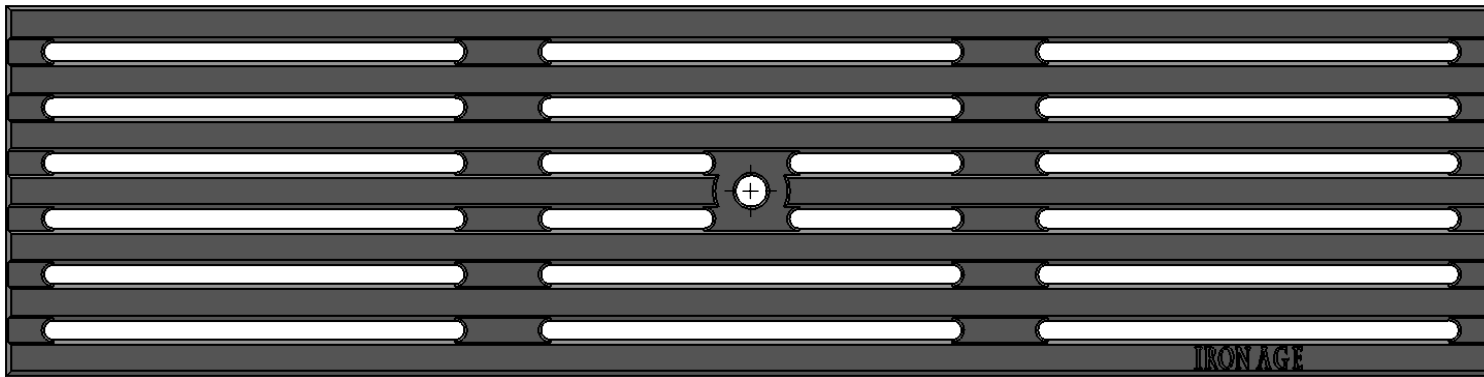

 **IRON AGE** 2104 SW 152nd st #4 TEL 206.276.0925  
DESIGNS Burién, WA 98166 FAX 206.257.0318  
www.ironagedesigns.com

Que 5x20 trench grate

JOB NO.

DWG. NO. QUE.I.5x20\_Alum

Drawn by: JH

Date: 12/28/12

Scale: NTS

**NOTES:**

1. Material: cast ductile iron
2. Natural finish
3. Edge thickness: 7/8"
4. No openings greater than 1/4"
5. Weight approx. <12lbs
6. Fits drain bodies manufactured by:  
ACO™ KS100S, H80K, H100K
7. Due to casting inconsistencies all dimensions are nominal

©2012 Iron Age Designs