

TOP VIEW  
scale 1:3

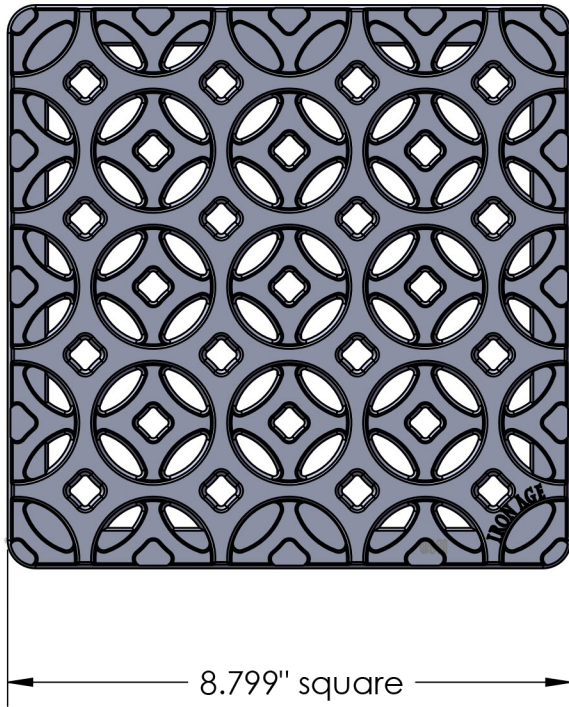

8.799" square

RIGHT VIEW  
scale 1:3

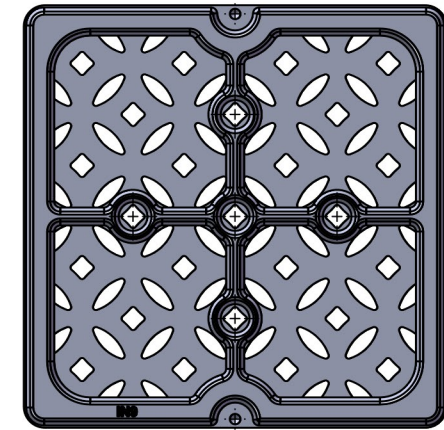
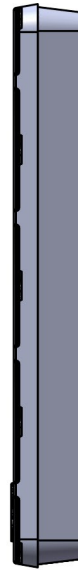

BOTTOM VIEW  
scale 1:4

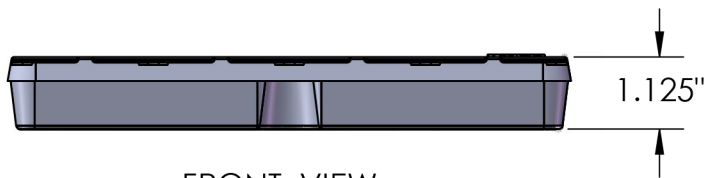

1.125"

FRONT VIEW  
scale 1:3

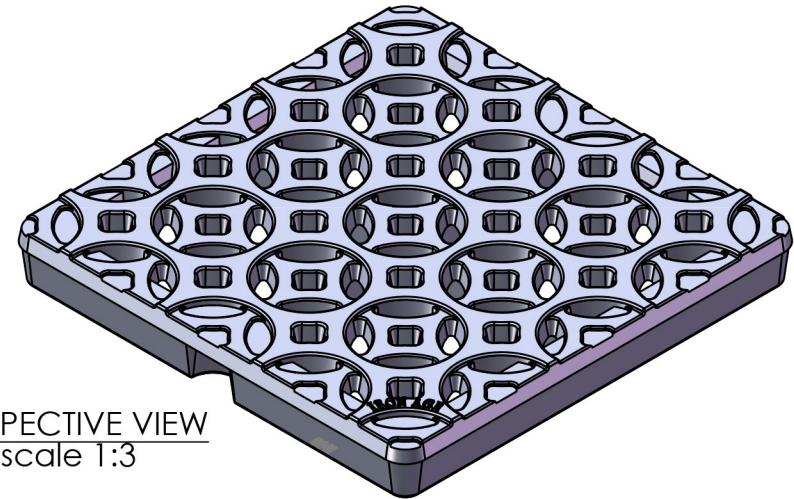

PERSPECTIVE VIEW  
scale 1:3

NOTES:

1. Material: cast ductile iron
2. Finish: Natural
3. Total Thickness: 1 1/8"
4. Fits catch basin manufactured by:  
NDS - 900™
5. No openings great than: 1/2"
6. Due to casting inconsistencies all dimensions are nominal

U.S. Patent D 575.881 © 2010 Iron Age Designs

**TRENCH DRAIN**  
SYSTEMS

www.TrenchDrainSystems.com

842 Graham Drive ~ Fremont, OH 43420  
(610) 638-1221

Interlaken 9" drain

DWG. NO. INT.N.09x09

Drawn by: CD  
Date: 03/25/10  
Scale: NTS