

TOP

11.6875"sq.

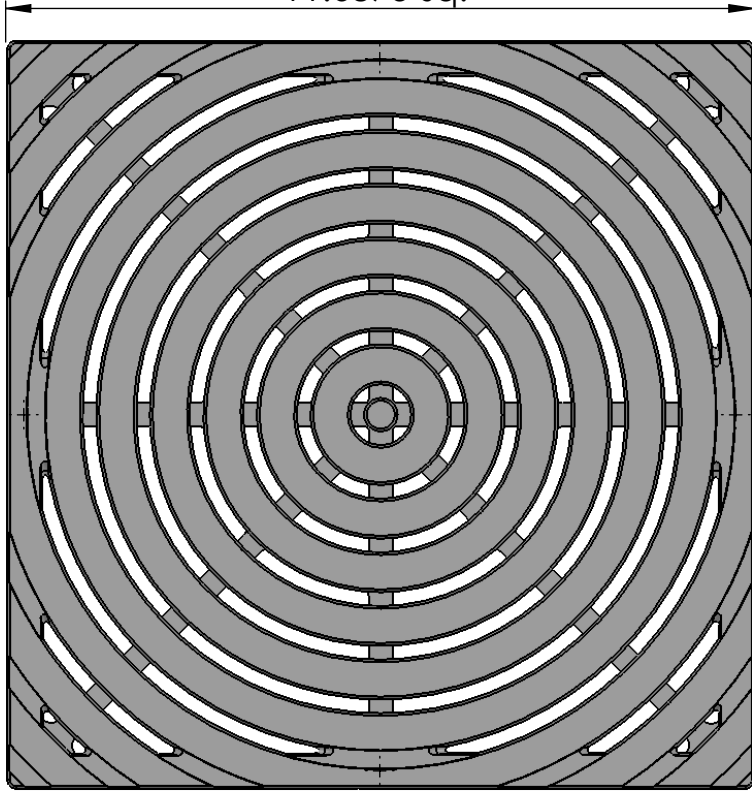

1.125"

EDGE

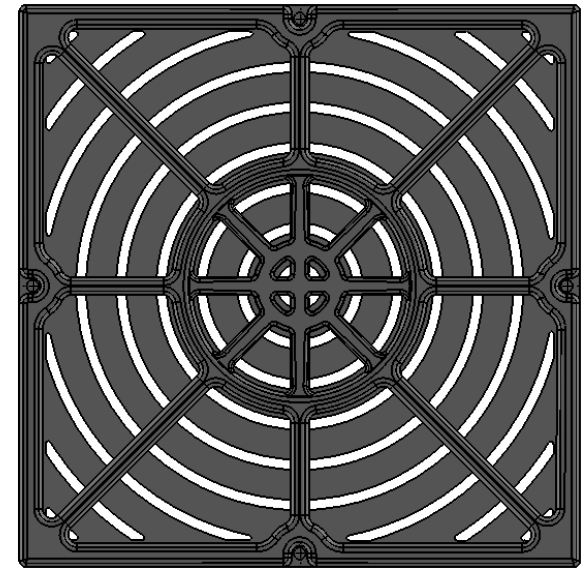

BACK

PERSPECTIVE

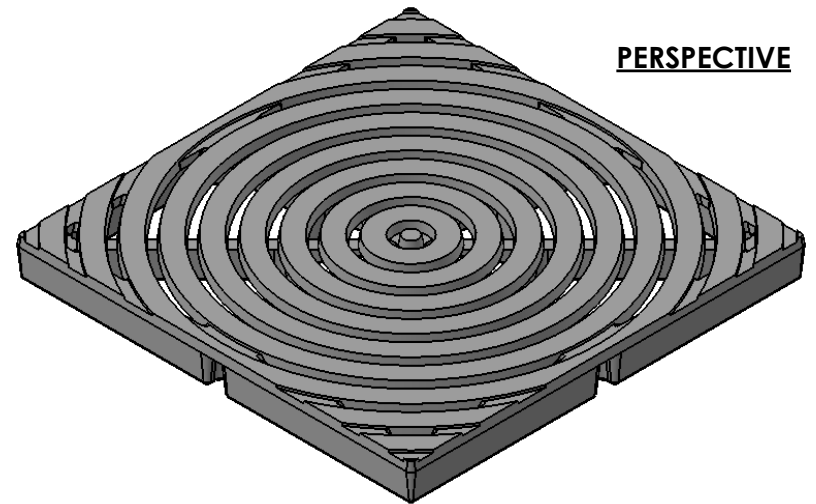

SIDE



NOTES:

1. Material: cast ductile iron
2. Finish: **Natural**
3. Edge thickness: 1.125"
4. Fits NDS 1200 Series Catch Basin
5. Heelproof; No openings larger than 1/4"
6. Weight approx. 15 lbs
7. Due to casting inconsistencies all dimensions are nominal

 **IRON AGE** 2104 SW 152nd st #4 TEL 206.276.0925
 Burién, WA 98166 FAX 206.257.0318
 DESIGNS www.ironagedesigns.com

Bullseye 12"x12" Catch Basin Grate

JOB NO. ...
 DWG. NO. 0BL.I.12x12_Bullseye
 Drawn by: JH
 Date: 1/20/15
 Scale: NTS